

# **EXHIBIT 1**

*EDDIE*  
*1519*

*1548*

*REMOVE*  
*DIRECT*  
*OVER HANG*

*10-19-07 Small Limbs just  
over prt, can trim  
w/ 20' lift. T+E  
for fly crew only*

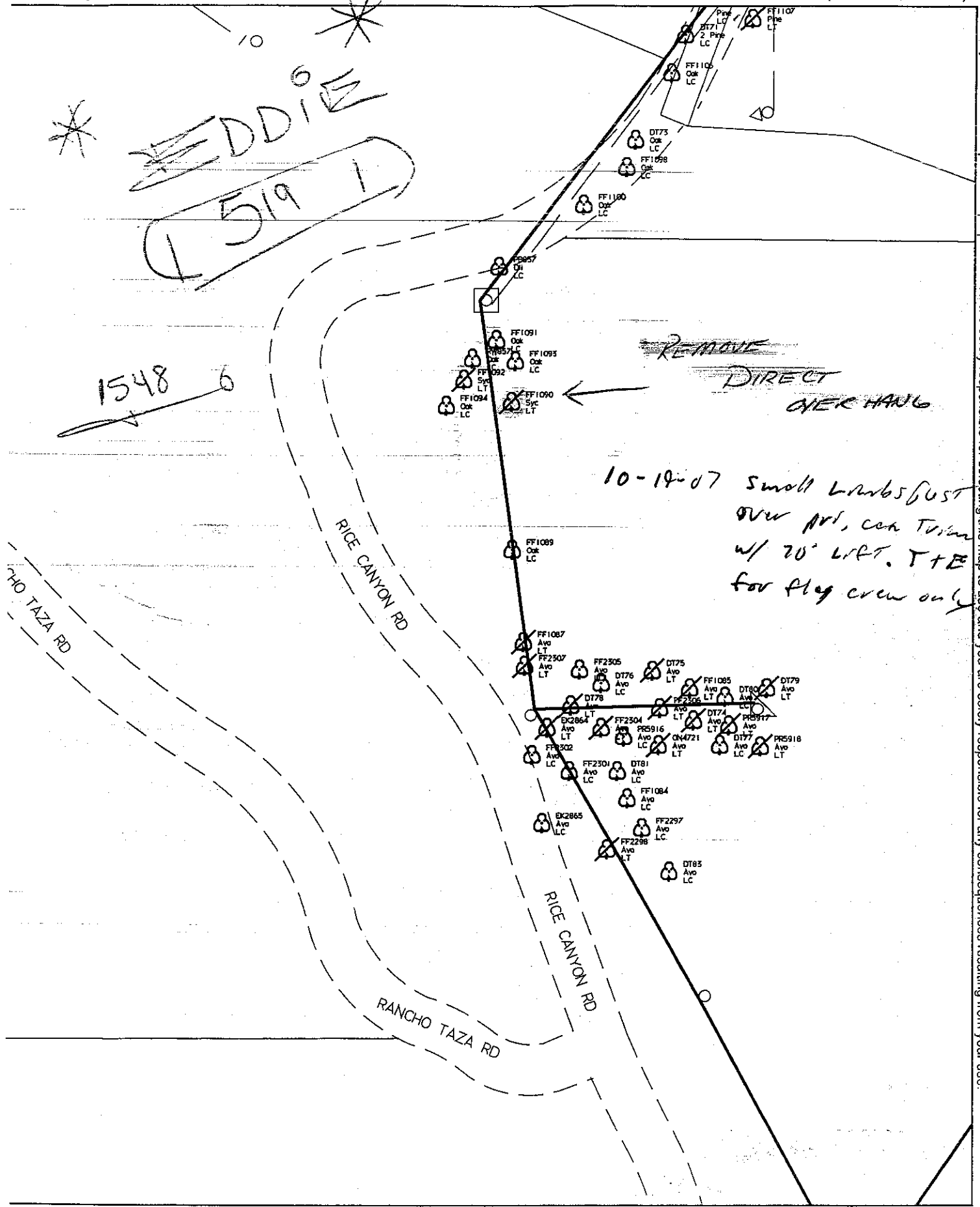

SDG&E is providing this map to you as a courtesy. SDG&E does not represent that the information contained herein is accurate. SDG&E disclaims all warranties, express or implied, including the warranty of fitness for a particular purpose. You are solely responsible for selecting this map to use and you are solely responsible for any consequences resulting from your use.



A Sempra Energy utility

# Tree Work Order Form

Tree ID



Month	Day	Year	Crew ID	Clearance	Tree Information From VMS
<input type="radio"/> Jan	0	<input type="radio"/> 06	0	<input type="radio"/> 0.0 to 2.0 ft.	<b>Address:</b> 1548 RICE CANYON RD FALLBROOK, CA 92028  <b>Poles:</b> P213072 - P112340 <b>TB:</b> 998J7  <b>Lat/Long:</b> 33.39861 N <b>Num Units:</b> 1 117.14473 W  <b>Climb or Lift:</b> Both <b>Species:</b> Sycamore  <b>DBH:</b> 36.0 - 41.9 <b>Voltage:</b> P  <b>Traffic Ctrl:</b> Yes
<input type="radio"/> Feb	1	<input type="radio"/> 07	1	<input type="radio"/> 2.1 to 4.0 ft.	
<input type="radio"/> Mar	2	<input type="radio"/> 08	2	<input type="radio"/> 4.1 to 5.9 ft.	
<input type="radio"/> Apr	3	<input type="radio"/> 09	3	<input type="radio"/> 6.0 to 7.9 ft.	
<input type="radio"/> May	4		4	<input type="radio"/> 8.0 to 9.9 ft.	
<input type="radio"/> Jun	5		5	<input type="radio"/> 10 to 11.9 ft.	
<input type="radio"/> Jul	6		6	<input type="radio"/> 12.0 to 14.9 ft.	
<input type="radio"/> Aug	7		7	<input type="radio"/> 15.0 to 19.9 ft.	
<input type="radio"/> Sep	8		8	<input type="radio"/> 20.0 to 30.0 ft.	
<input type="radio"/> Oct	9		9		
<input type="radio"/> Nov					
<input type="radio"/> Dec					

**Chemical**

SK26

OUST

GLN4

PF2

Accord

**Property Notes:**  
Beware of Dog(s); Matt Jane 760 723-4157;

**Equipment**

Split Dump

Crane

Standard Lift

70 ft. Lift

100 ft. Lift

**Tree Notes:**  
Poison oak; Remove direct overhang;

*NOTIFY off 10.10.07*

**Work Completed**

Pruned

Partial Pruning

No Trimming Required

Removed - Must add Ticket ID and DBH (Fill out Removal ID Below and DBH Above)

--	--	--	--	--	--	--	--	--	--	--	--	--	--	--	--	--	--	--	--

Refused - Must add Ticket ID (Fill Out Refusal ID Below)

--	--	--	--	--	--	--	--	--	--	--	--	--	--	--	--	--	--	--	--

**DBH - FOR REMOVAL USE ONLY!**

<input type="radio"/> 0 to 2.9 in.	<input type="radio"/> 36 to 41.9 in.
<input type="radio"/> 3 to 7.9 in.	<input type="radio"/> 42 to 47.9 in.
<input type="radio"/> 8 to 12.9 in.	<input type="radio"/> 48 to 53.9 in.
<input type="radio"/> 13 to 17.9 in.	<input type="radio"/> 54 to 59.9 in.
<input type="radio"/> 18 to 23.9 in.	<input type="radio"/> 60 to 80 in.
<input type="radio"/> 24 to 35.9 in.	

**Crew Type**

CMP Crew

Climbing Crew

Cleanup Crew

Lift Crew

Extended Lift Crew

Stump Removal Crew

Tree Removal Crew

100 ft. Lift Crew

Field Foreman

Groundsman

**Crew Time Spent**

	Crew Time Spent	
	Hours	Minutes
0	<input type="radio"/> 0	<input type="radio"/> 0
1	<input type="radio"/> 1	<input type="radio"/> 1
2	<input type="radio"/> 2	<input type="radio"/> 2
3	<input type="radio"/> 3	<input type="radio"/> 3
4	<input type="radio"/> 4	<input type="radio"/> 4
5	<input type="radio"/> 5	<input type="radio"/> 5
6	<input type="radio"/> 6	<input type="radio"/> 6
7	<input type="radio"/> 7	<input type="radio"/> 7
8	<input type="radio"/> 8	<input type="radio"/> 8
9	<input type="radio"/> 9	<input type="radio"/> 9

**Time and Equipment Conversion**

Convert to T&E (Time and Equipment)

**Crew Count**

1

2

3

**Crew Time Category**

Regular Time

Overtime

Double-Time

Per Diem

## **EXHIBIT 2**

DAVEY TREE SCHEDULE  
CYCLE 10

10-16-07 Meeting

Crews: 26 & memo

#	VMA NAME	SDGE START	Work Released	Printed	Work Completion		Cert. Issued	LTs	Added Trees	Est. Comp	Notifier	General Foremen		%Scanned	Tree Trimming Remaining
					Due	Cert.due						Foremen	Foremen		
360	Pauma Valley 1	9/1/07	8/27/07	8/28/07	11/1/07	11/5/07		1584			Shari	J. Orellana		95%	84
378	Pala	9/1/07	8/27/07	8/28/07	11/1/07	11/5/07		338			Shari	J. Orellana		60%	134
379	Rainbow 1	9/1/07	8/27/07	9/6/07	11/1/07	11/5/07		1152			Shari	J. Orellana		44%	570
388	Rainbow 2	9/1/07	8/27/07	9/7/07	11/1/07	11/5/07		873			Shari	J. Orellana		28%	506
701	San Clemente	9/1/07	8/27/07	8/28/07	11/1/07	11/5/07		827	109 C.A. includes city		Simi	R. Willis		85%	121
702	Dana Point 1	9/1/07	8/27/07	9/7/07	11/1/07	11/5/07		389	includes city		Simi	R. Willis		94%	24
703	San Juan Capistrano	9/1/07	8/27/07	9/7/07	11/1/07	11/5/07		790			Simi	R. Willis		63%	259
707	Laguna Hills	9/1/07	8/27/07	9/6/07	11/1/07	11/5/07		216			Simi	R. Willis		64%	44
708	Dana Point 2	9/1/07	8/27/07	9/6/07	11/1/07	11/5/07		178	includes city		Simi	R. Willis		24%	120
752	Ortega	9/1/07	8/27/07	8/28/07	11/1/07	11/5/07	10/9/07	93			Simi	R. Willis		100%	136
361	Pauma Valley 2	10/1/07	9/26/07	10/1/07	12/1/07	12/5/07		831			Simi	R. Willis		0%	2,137
364	Cousser Canyon 1	10/1/07	9/26/07	10/5/07	12/1/07	12/5/07		1,561			Shari	J. Orellana		0%	831
370	Palomar Mtn 2	10/1/07	9/26/07	10/12/07	12/1/07	12/5/07		504			Shari	J. Orellana		0%	1,561
375	Palomar Mtn 1	10/1/07	9/26/07	10/12/07	12/1/07	12/5/07		682			Shari	J. Orellana		0%	504
607	Oceanside North 1	10/1/07	9/26/07	10/8/07	12/1/07	12/5/07		692			Simi	R. Willis		0%	682
611	Oceanside South	10/1/07	9/26/07	9/27/07	12/1/07	12/5/07		741			Simi	R. Willis		0%	692
616	Oceanside North 2	10/1/07	9/26/07	10/1/07	12/1/07	12/5/07		870			Simi	R. Willis		0%	741
															870
															5,881

VMA 378

1548 Rice Canyon Rd - Review FF1090 (5yr) for THE for overhanging position over  
VMA 703

32701 Alijoz St. - Refusal - Cust don't want 3 weinmans trimmed. \*Gave To G Peck  
32011 Del Obispo St. - Refusal - Bird of Paradise won't hold. \*Gave To G. Peck

VMA 708

33781 Alcazar Dr. - Signed bubble NTR (FC1578), Talk w/ OC district to change to Triplex

\* Shari Holbrook told cust. at 774 Rainbow crest what trees need trim (to trim himself). Asked D. Foley to talk to her and bring documentation to D. Foley  
\* VMA 702 + 708 may have some City of Dana trees scanned NTR by accident  
\* Asked Davey to review OC VMA's for Doc tails (incorrect CT clearances) before certing. Found several locations where trees were CT'd with non-compliant clearances.